



EXHIBIT  
tabbles®  
2

2000 I-30 E  
Greenville, TX 75402

Wednesday, January 5, 2022

Office of Hopkins County Judge  
PO Box 288  
Sulphur Springs TX 75483

Farmers Electric Cooperative Member: JEFF ODOM  
Service Order Number: 2021125638

Greetings:

Farmers Electric Cooperative, Inc. is requesting permission to construct electrical power distribution facilities which will cross County Road 1152 which is located 980 ft north of CR 1153 in Hopkins County, Texas.

Site location map and construction sketches are enclosed. The construction sketch details the proposed work. All road crossings will have a minimum vertical clearance of 22 feet.

If you have any questions, please contact me at any time.

Sincerely,

*Joshua Eden*

Project Coordinator  
jeden@farmerselectric.coop  
Phone 903-268-6873

Submitted by Brandon Darrow  
bdarrow@farmerselectric.coop  
Field Engineering Coordinator

Enclosures

---

County Approval Section:

Approved: \_\_\_\_\_

Denied: \_\_\_\_\_

Authorized Signature: \_\_\_\_\_

Date: 1-10-22

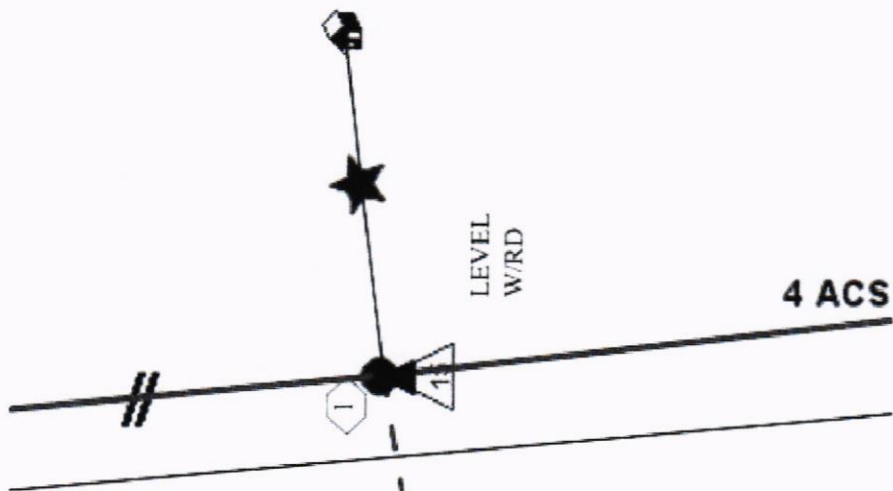

MBR CLEAR TREE  
CREW TRIM UPPER LIMBS

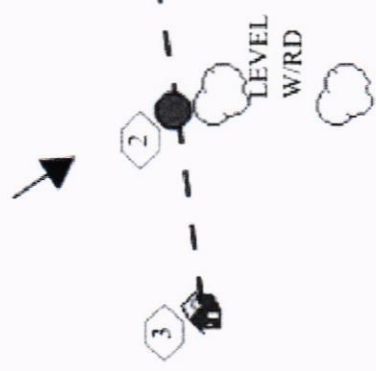

P2 IS 26' FROM CR 1152  
AND 980' FROM CR 1153

County Road 1152

961580

014500

Jef Odom  
Service Order#  
2021125638  
Cross CR 1152 at  
Pole# 054902

161730

County Road 1152

County Road 1152

051624

